

**VALVOLE DI SFIATO**

Adatta all'estrazione di aria da condutture, cisterne o attrezzature che devono funzionare in assenza di aria.

Corpo in poliammide rinforzato con fibra di vetro. Guarnizione principale in Poliuretano resistente ai prodotti chimici utilizzati in agricoltura, ai depositi calcarei e ai microrganismi. Disponibile in due esecuzioni.

**Semplice effetto (FD1 e FD2):**

- Espelle l'aria dalle tubazioni durante il riempimento
- Elimina eventuali bolle di aria che possono formarsi nelle tubazioni durante il funzionamento dell'impianto

**Doppio effetto (FX1 e FX2):**

- Espelle l'aria dalle tubazioni durante il riempimento
- Elimina eventuali bolle di aria che possono formarsi nelle tubazioni durante il funzionamento dell'impianto
- Consente l'immissione di aria nell'impianto per evitare lo schiacciamento delle tubazioni durante lo svuotamento delle condutture

**AIR RELEASE VALVES**

Suitable to extract efficiently the air trapped in pipes, tanks and other places where unwanted air may cause problems.

Body made of fiber-glass reinforced Polyamide. Main gasket made of polyurethane resistant to chemicals used in agriculture, to calcareous deposits and to the action of micro-organisms. Available in two solutions:

**Simple effect (FD1 and FD2):**

- It extracts the air from the pipes during filling
- It eliminates air bubbles that may be in piping during working of the system

**Double effect (FX1 and FX2):**

- It extracts the air from the pipes during filling
- It eliminates air bubbles that may be in piping during working of the system
- It allows air to enter into the system to avoid pipe crushing during un-filling

**VALVULAS VENTOSAS**

Diseñada para expulsar el aire acumulado en tuberías, tanques y en cualquier lugar donde la presencia del aire es un problema.

Cuerpo en Poliamida reforzado con fibra de vidrio. Junta principal en Poliuretano especialmente resistente a los agentes químicos contenidos en abonos y tratamientos agrícolas, a las incrustaciones calcáreas o de microorganismos. Disponible en dos soluciones:

**Simple efecto (FD1 y FD2):**

- Extrae el aire de las tuberías mientras se llenan
- Mantiene de modo automático y continuo su función de purgado durante el funcionamiento

**Doble efecto (FX1 y FX2):**

- Extrae el aire de las tuberías mientras se llenan
- Mantiene de modo automático y continuo su función de purgado durante el funcionamiento
- Protege a la tubería del eplostamiento, bajando el flotador y abriendo el cierre con lo que el aire penetra en la tubería de forma inmediata

**Valvole di sfiato G 1" maschio****Air release valves 1" BSP male****Valvulas ventosas G 1" macho**

COD.	Tipo Type Tipo	Pressione Pressure Presión (bar)		Aria estratta Extracted air Aire extraído
		min	MAX	
FD1	Semplice effetto Simple effect Simple efecto	0.2	16	95 m <sup>3</sup> /h @ 0.2 bar
FX1	Doppio effetto Double effect Doble efecto	0.2	12	25 m <sup>3</sup> /h @ 0.7 bar

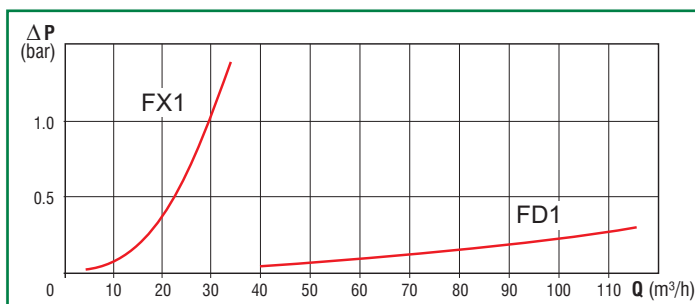
**Valvole di sfiato G 2" maschio****Air release valves 2" BSP male****Valvulas ventosas G 2" macho**

COD.	Tipo Type Tipo	Pressione Pressure Presión (bar)		Aria estratta Extracted air Aire extraído
		min	MAX	
FD2	Semplice effetto Simple effect Simple efecto	0.2	16	365 m <sup>3</sup> /h @ 0.3 bar
FX2	Doppio effetto Double effect Doble efecto	0.2	16	200 m <sup>3</sup> /h @ 0.3 bar

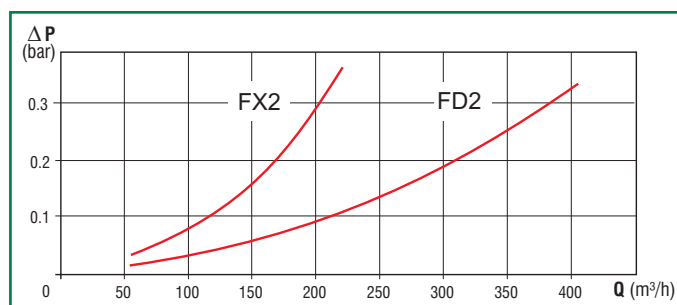

**Serie di raccordi maschio e femmina in polipropilene con filettatura GAS, maggiore resistenza alla pressione e sistema di tenuta con OR.**

Tutti i raccordi della gamma ARAG sono dotati di una sede in cui inserire l'apposito O'ring di tenuta (Misure e codici per ordinare, a pag. 27).

Con questo sistema si conferisce, all'accoppiamento fra raccordi maschio / femmina, maggiore tenuta ed un'ottima resistenza alla pressione, senza l'ausilio di paste sigillanti o nastri in Teflon.

**Polypropilene series of male and female BSP thread fittings, with enhanced strength under pressure and OR sealing system.**

All ARAG fittings include an o-ring seat.

Please go to page 27 for dimensions and coding.

This system ensures increased sealing and improved pressure strength to male/female coupled connectors without using any sealants or Teflon tape.

**Serie de racores en polipropileno macho y hembra roscado GAS, con mayor resistencia a la presión y sistema de estanqueidad con OR.**

Todos los acoples de la gama ARAG están dotados de un alojamiento para introducir el específico O-Ring de estanqueidad (Medidas y códigos para ordenar en pág. 27). Con este sistema la unión entre los acoples macho / hembra tienen una mayor estanqueidad y una óptima resistencia a la presión, sin la necesidad de agregar pastas selladoras o cintas de Teflón.

Schema di montaggio raccordi con tenuta tramite OR  
Assembly diagram for fittings with OR seal  
Esquema de montaje racores con estanqueidad mediante OR

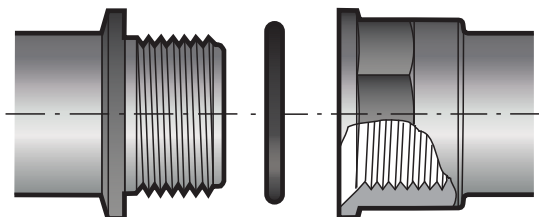

**Raccordo curvo 90° femmina/femmina**  
Female/female 90° fitting  
Racor curvo 90° hembra/hembra

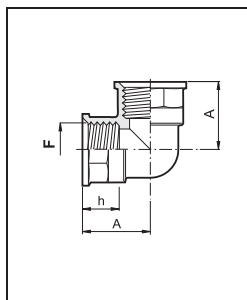

COD.	F (BSP)	PRESS (bar)	h (mm)	A (mm)	
120 2022	G1/2	10	21	33.5	25
120 2033	G3/4	10	23	38.5	25
120 2044	G1	10	23	42.5	25
120 2055	G1 1/4	10	25	50	10
120 2066	G1 1/2	6	25	52.5	10
120 2077	G2	6	28	62.5	10
120 2099	G3	5	36	84.5	10



**Raccordo curvo 90° maschio/femmina**  
Male/female 90° fitting  
Racor curvo macho/hembra

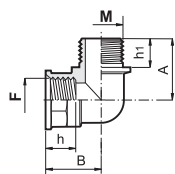

COD.	F/M (BSP)	PRESS (bar)	h (mm)	h1 (mm)	A (mm)	B (mm)	
126 2022	G1/2	10	21	18	35	33.5	25
126 2033	G3/4	10	23	22	40.5	38.5	25
126 2044	G1	10	23	22	47	42.5	25
126 2055	G1 1/4	10	25	24	53	50	10
126 2066	G1 1/2	6	25	24	57	52.5	10
126 2077	G2	6	28	27	66	62.5	10



**Raccordo curvo 90° maschio/maschio**  
Male/male 90° fitting  
Racor curvo 90° macho/macho

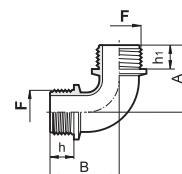

COD.	M (BSP)	PRESS (bar)	h (mm)	h1 (mm)	A (mm)	B (mm)	
123 044	G1	10	19.5	19.5	54	54	25
123 055	G1 1/4	10	20.5	20.5	66.5	64.5	10
123 255	G1 1/4	10	23	40.5	79.5	55	10
123 2077	G2	6	27	27	89	89	10



Raccordo a "T" femmina  
Female Tee  
Racor en "T" hembra

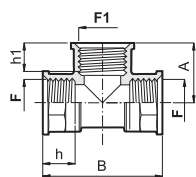

COD.	F (BSP)	F1 (BSP)	PRESS (bar)	h (mm)	h1 (mm)	A (mm)	B (mm)	
130 2020	G1/2	G1/2	10	21	21	33.5	67	25
130 2032	G1/2	G3/4	10	21	23	38.5	67	25
130 2030	G3/4	G3/4	10	23	23	38.5	77	25
130 2023	G3/4	G1/2	10	23	21	38.5	77	25
130 2040	G1	G1	10	23	23	42.5	85	10
130 2050	G1 1/4	G1 1/4	10	25	25	50	100	10
130 2060	G1 1/2	G1 1/2	6	25	25	52.5	105	10
130 2070	G2	G2	6	28	28	62.5	125	10



Raccordo a "T" maschio/femmina  
Male/female Tee  
Racor en "T" macho/hembra

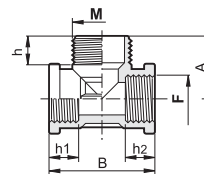

COD.	M (BSP)	F (BSP)	PRESS (bar)	h (mm)	h1 (mm)	h2 (mm)	A (mm)	B (mm)	
133 024	G1	G1/2	10	16	17.5	17.5	35	60	25
133 034	G1	G3/4	10	16	16.5	16.5	35	60	25



Raccordo a "T" femmina/maschio  
Female/male Tee  
Racor en "T" hembra/macho

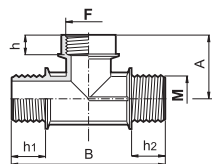

COD.	M (BSP)	F (BSP)	PRESS (bar)	h (mm)	h1 (mm)	h2 (mm)	A (mm)	B (mm)	
132 040	G1	G1	10	23	22	22	42	98	25
132 050	G1 1/4	G1 1/4	10	18	16	31	58.5	126	10
132 2070	G2	G2	6	28	27	27	67.5	135	10



Raccordo a "T" maschio  
Male Tee  
Racor en "T" macho

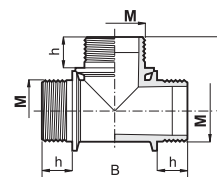

COD.	M (BSP)	PRESS (bar)	h (mm)	A (mm)	B (mm)	
131 2050	G1 1/4	10	24	54	108	10
131 2060	G1 1/2	6	24	57.5	115	10
131 2070	G2	6	27	67.5	135	10



Nipplo simmetrico  
Symmetrical nipple  
Unión simétrico

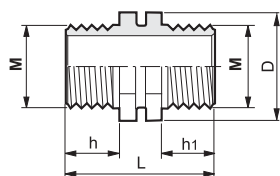

COD.	M (BSP)	PRESS (bar)	h (mm)	h1 (mm)	L (mm)	D (mm)	
250 2020	G1/2	10	18	18	48	32	25
250 2030	G3/4	10	22	22	56	40	25
250 2040	G1	10	22	22	56	45	25
250 2050	G1 1/4	10	24	24	62	56	25
250 2060	G1 1/2	6	24	24	62	62	10
250 2070	G2	6	27	27	68	76	10
250 2080	G2 1/2	6	32	32	78	92	10
250 2090	G3	5	35	35	84	106	10



Nipplo passaparete  
Bulkhead nipple  
Unión pasapared

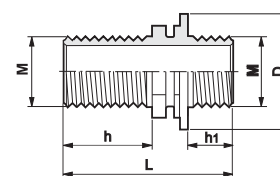

COD.	M (BSP)	PRESS (bar)	h (mm)	h1 (mm)	L (mm)	D (mm)	
250 2021	G1/2	10	38	18	68	32	25
250 2031	G3/4	10	40	22	74	40	25
250 2041	G1	10	45	22	79	45	25
250 2051	G1 1/4	10	54	24	88	56	25
250 2061	G1 1/2	6	50	24	88	62	10
250 2071	G2	6	50	27	91	76	10
250 2081	G2 1/2	6	65	32	111	92	10
250 2091	G3	5	73	35	122	106	10

Guarnizioni, pagina 27  
Gaskets, page 27  
Juntas, page 27



**Manicotto**  
Threaded coupling  
Manguito

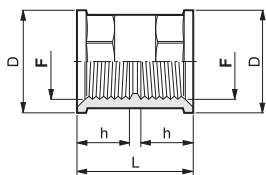

COD.	F (BSP)	PRESS (bar)	h (mm)	L (mm)	D (mm)	
230 2010	G3/8	10	17	38	27	25
230 2020	G1/2	10	19	43	32	25
230 2030	G3/4	10	23	51	40	25
230 2040	G1	10	23	51	45	25
230 2050	G1 1/4	10	25	55	56	25
230 2060	G1 1/2	6	25	55	62	10
230 2070	G2	6	28	61	76	10

Guarnizioni, pagina 27  
Gaskets, page 27  
Juntas, page 27



**Riduzione Maschio / Maschio**  
Male / Male reducer nipple  
Reduccion Macho / Macho

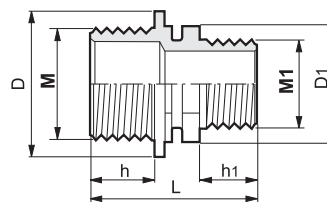

COD.	M (BSP)	M1 (BSP)	PRESS (bar)	h (mm)	h1 (mm)	L (mm)	D (mm)	D1 (mm)	
240 2020	G1/2	G1/4	10	18	13	43	32	21	25
240 2021	G1/2	G3/8	10	18	16	46	32	27	25
240 2031	G3/4	G3/8	10	22	16	50	40	27	25
240 2032	G3/4	G1/2	10	22	18	52	40	32	25
240 2042	G1	G1/2	10	22	18	52	45	32	25
240 2043	G1	G3/4	10	22	22	56	45	40	25
240 2053	G1 1/4	G3/4	10	24	22	60	56	40	25
240 2054	G1 1/4	G1	10	24	22	60	56	45	25
240 2064	G1 1/2	G1	6	24	22	60	62	45	10
240 2065	G1 1/2	G1 1/4	6	24	24	62	62	56	10
240 2075	G2	G1 1/4	6	27	24	65	76	56	10
240 2076	G2	G1 1/2	6	27	24	65	76	62	10
240 2087	G2 1/2	G2	6	32	27	73	93	76	10
240 2097	G3	G2	5	35	27	76	106	76	10
240 2098	G3	G2 1/2	5	35	32	81	106	93	10



**Riduzione Femmina / Femmina**  
Female / Female reducer nipple  
Reduccion Hembra / Hembra

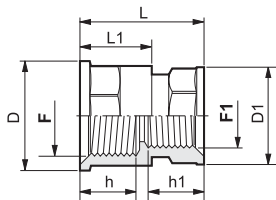

COD.	F (BSP)	F1 (BSP)	PRESS (bar)	h (mm)	h1 (mm)	L (mm)	L1 (mm)	D (mm)	D1 (mm)	
235 2010	G3/8	G1/4	10	18	14	35	23	27	21	25
235 2020	G1/2	G1/4	10	19	14	37.5	25.5	32	21	25
235 2021	G1/2	G3/8	10	19	17	40.5	25.5	32	27	25
235 2031	G3/4	G3/8	10	23	17	44.5	29.5	40	27	25
235 2032	G3/4	G1/2	10	23	19	47	29.5	40	32	25
235 2042	G1	G1/2	10	23	19	47	29.5	45	32	25
235 2043	G1	G3/4	10	23	23	51	29.5	45	40	25
235 2053	G1 1/4	G3/4	10	25	23	53	32	56	40	25
235 2054	G1 1/4	G1	10	25	23	53	32	56	45	25
235 2064	G1 1/2	G1	6	25	23	53	32	62	45	10
235 2065	G1 1/2	G1 1/4	6	25	25	55	32	62	56	10
235 2075	G2	G1 1/4	6	28	25	58	35	76	56	10
235 2076	G2	G1 1/2	6	28	25	58	35	76	62	10



**Riduzione Maschio / Femmina**  
Male / Female reducer nipple  
Reduccion Macho / Hembra

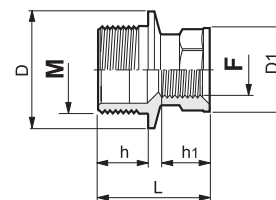

COD.	M (BSP)	F (BSP)	PRESS (bar)	h (mm)	h1 (mm)	L (mm)	D (mm)	D1 (mm)	
245 010	G3/8	G1/4	10	13	10	23	22	22	25
245 2032	G3/4	G1/2	10	22	19	47.5	40	32	25
245 2042	G1	G1/2	10	22	19	47.5	45	32	25
245 2043	G1	G3/4	10	22	23	51.5	45	40	25
245 2053	G1 1/4	G3/4	10	24	23	53.5	56	40	25
245 2054	G1 1/4	G1	10	24	23	53.5	56	45	25
245 2064	G1 1/2	G1	6	24	23	53.5	62	45	10
245 2065	G1 1/2	G1 1/4	6	24	25	56	62	56	10
245 2075	G2	G1 1/4	6	27	25	59	76	56	10
245 2076	G2	G1 1/2	6	27	25	59	76	62	10



**Manicotto Maschio / Femmina**  
Male / Female threaded coupling  
Manguito Macho / Hembra

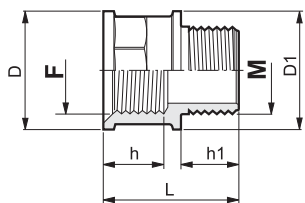

COD.	M (BSP)	F (BSP)	PRESS (bar)	h (mm)	h1 (mm)	L (mm)	D (mm)	D1 (mm)	
245 2022	G1/2	G1/2	10	19	18	43.5	32	32	25
245 2033	G3/4	G3/4	10	23	22	51.5	40	40	25
245 2044	G1	G1	10	23	22	51.5	45	45	25
245 2055	G1 1/4	G1 1/4	10	25	24	56	56	56	25
245 2066	G1 1/2	G1 1/2	6	25	24	56	62	62	10
245 2077	G2	G2	6	28	27	62	76	76	10



**Riduzione Femmina / Maschio**  
Female / Male reducer nipple  
Reduccion Hembra / Macho

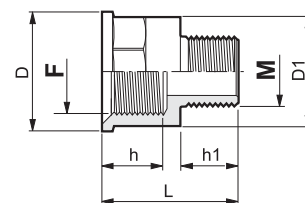

COD.	F (BSP)	M (BSP)	PRESS (bar)	h (mm)	h1 (mm)	L (mm)	D (mm)	D1 (mm)	
245 2001	G3/8	G1/4	10	17	11	36	27	22	25
245 2002	G1/2	G1/4	10	19	13	38.5	32	21	25
245 2012	G1/2	G3/8	10	19	16	41.5	32	27	25
245 2013	G3/4	G3/8	10	23	16	45.5	40	27	25
245 2023	G3/4	G1/2	10	23	18	47.5	40	32	25
245 2024	G1	G1/2	10	23	18	47.5	45	32	25
245 2034	G1	G3/4	10	23	22	51.5	45	40	25
245 2035	G1 1/4	G3/4	10	25	22	54	56	40	25
245 2045	G1 1/4	G1	10	25	22	54	56	45	25
245 2046	G1 1/2	G1	6	25	22	54	62	45	10
245 2056	G1 1/2	G1 1/4	6	25	24	56	62	56	10
245 2057	G2	G1 1/4	6	28	24	59	76	56	10
245 2067	G2	G1 1/2	6	28	24	59	76	62	10
245 2079	G3	G2	5	27	25	60	106	106	10



**Tappo maschio**  
Male plug  
Tapón macho

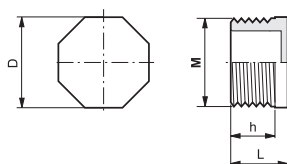

COD.	F (BSP)	PRESS (bar)	h (mm)	L (mm)	D (mm)	
215 001	G1/4	10	9	15	17	25
215 010	G3/8	10	10.5	22	24	25
215 020	G1/2	10	15.5	23	24	25
215 2030	G3/4	10	17	27	29	25
215 040	G1	10	19	30	36	25
215 050	G1 1/4	10	21	27	43	25



**Ghiera**  
Lock ring  
Tuerca

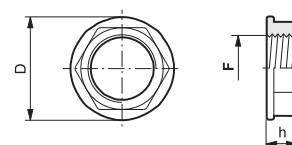

COD.	F (BSP)	h (mm)	D (mm)	
205 2020	G1/2	13	34	25
205 2030	G3/4	13	44	25
205 2040	G1	15.5	50	25
205 2050	G1 1/4	14.3	59	25
205 2060	G1 1/2	15	67	25
205 2070	G2	19.5	80	10
205 2080	G2 1/2	20	100	10
205 2090	G3	22	110	10



**Tappo femmina**  
Blanking cap  
Tapón hembra

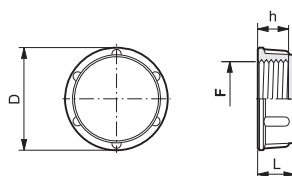

COD.	F (BSP)	PRESS (bar)	h (mm)	L (mm)	D (mm)	
210 005	G1/4	10	7.5	10.5	19	25
210 010	G3/8	10	14	18	29	25
210 2020	G1/2	10	13	17.5	31	25
210 2030	G3/4	10	13.5	18	38	25
210 2040	G1	10	17.5	22	46	25
210 2050	G1 1/4	10	18	23.5	57	25
210 2060	G1 1/2	6	19	25	64	25
210 2070	G2	6	19	25.5	77	10
210 2080	G2 1/2	6	20	26.5	92	10
210 2090	G3	5	25.5	32.5	105	10

Guarnizioni, pagina 27  
Gaskets, page 27  
Juntas, page 27



**Raccordo portagomma dritto filetto maschio**  
**Straight hose fitting with male thread**  
**Racor portamangueras recto rosca macho**

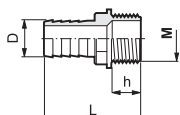

COD.	M (BSP)	PRESS (bar)	D (mm)	h (mm)	L (mm)	
103 2008	G1/4	10	8	13	47	25
103 2010		10	10	13	52	25
103 2013		10	13	13	52	25
103 2108	G3/8	10	8	16	52	25
103 2110		10	10	16	57	25
103 2113		10	13	16	57	25
103 2115		10	16	16	57	25
103 2210	G1/2	10	10	18	60	25
103 2213		10	13	18	60	25
103 2215		10	16	18	60	25
103 2220		10	20	18	65	25
103 2313	G3/4	10	13	22	66	25
103 2315		10	16	22	66	25
103 2320		10	20	22	71	25
103 2322		10	22	22	71	25
103 2325		10	25	22	71	25
103 2420	G1	10	20	22	72.5	25
103 2422		10	22	22	72.5	25
103 2425		10	25	22	72.5	25
103 2430		10	30	22	77.5	25
103 2432		10	32	22	77.5	25
103 2520		G1 1/4	10	20	24	75
103 2525	10		25	24	75	25
103 2530	10		30	24	80	25
103 2532	10		32	24	80	25
103 2535	10		35	24	85	25
103 2538	10		38	24	85	25
103 2540	10		40	24	90	25
103 2630	G1 1/2		6	30	24	80
103 2632		6	32	24	80	10
103 2635		6	35	24	85	10
103 2638		6	38	24	85	10
103 2640		6	40	24	90	10
103 2645		6	45	24	90	10
103 2650	G2	6	50	24	95	10
103 2750		6	50	27	101	10
103 2760		6	60	27	112.5	10
103 2860	G2 1/2	6	60	32	120	10
103 2975	G3	5	75	35	138.5	10

**GUARNIZIONI DI RICAMBIO SPARE GASKETS JUNTAS DE REPUESTO**

**Guarnizioni per raccordi a tenuta con OR**  
**Gaskets for OR seal fittings**  
**Juntas para racores con estanqueidad con OR**

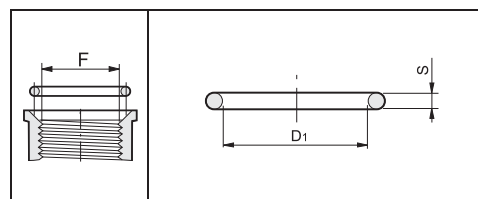

F (BSP)	COD.	D1 (mm)	S (mm)	
G1/2	G 10041	20.2	2.6	50
G3/4	G 11058	25	2.6	50
G1	G 11059	29.8	2.6	50
G1 1/4	G 10052	39.7	3.5	50
G1 1/2	G 10062	47.2	3.5	50
G2	G 10073	58.7	3.5	25
G2 1/2	G 10082	74.6	3.5	25
G3	G 10092	85.5	3.5	10

**Guarnizioni per tappi femmina**  
**Gaskets for blanking caps**  
**Juntas para tapones hembra**

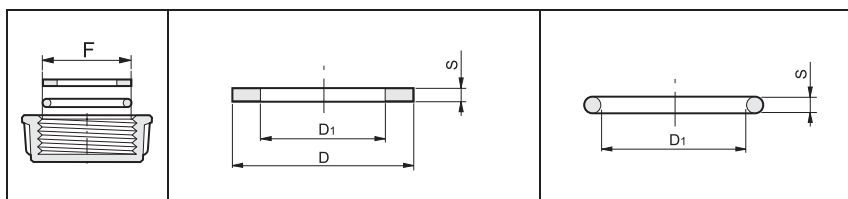

F	COD.	D (mm)	D1 (mm)	S (mm)		COD.	D1 (mm)	S (mm)	
G3/8 (BSP)	---	---	---	---	---	G 11068	12	2.6	50
G1/2 (BSP)	---	---	---	---	---	G 10020	14	3	50
G3/4 (BSP)	G 40013	24.5	17	2.5	50	---	---	---	---
G1 (BSP)	G 40014	30.7	20	2.5	50	---	---	---	---
G1 1/4 (BSP)	G 40015	39.5	27.5	2.5	50	---	---	---	---
G1 1/2 (BSP)	G 40004	45	33	3	50	---	---	---	---
G2 (BSP)	G 40005	60	40	4	50	---	---	---	---
G2 1/2 (BSP)	G 40010	75	55	4	25	---	---	---	---
G3 (BSP)	G 40007	86	59	4	25	---	---	---	---

**Guarnizioni per filetti maschio passaparete**  
**Gaskets for bulkhead male threads**  
**Juntas para roscas macho pasapared**

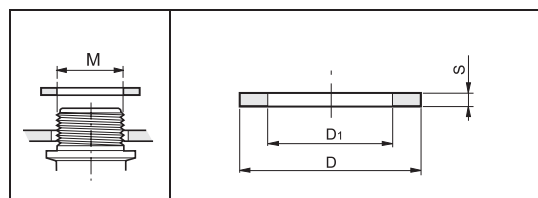

M	COD.	D (mm)	D1 (mm)	S (mm)	
G1/2 (BSP)	G 40002	33	21	2	50
G3/4 (BSP)	G 40015	39.5	27.5	2.5	50
G1 (BSP)	G 40004	45	33	3	50
G1 1/4 (BSP)	G 40005	60	40	4	50
G1 1/2 (BSP)	G 40006	67	47	3	50
G2 (BSP)	G 40007	86	59	4	25
G2 1/2 (BSP)	G 40008	94.5	76	4	25
G3 (BSP)	G 40009	110	90	4	25

**A** Adattatore maschio / Filetto femmina  
 Male adapter / Female thread  
 Adaptador macho / Rosca hembra

COD.	Corpo Size Cuerpo	F (BSP)
181 03A2	3/4"	G 1/2
181 03A	3/4"	G 3/4
181 04A	1"	G 1
181 05A	1 1/4"	G 1 1/4
181 06A5	1 1/2"	G 1 1/4
181 06A	1 1/2"	G 1 1/2
181 07A	2"	G 2
181 09A8	3"	G 2 1/2
181 09A	3"	G 3
181 0AA	4"	G 4

**B** Accoppiatore femmina / Filetto maschio  
 Female coupler / Male thread  
 Acople hembra / Rosca macho

COD.	Corpo Size Cuerpo	M (BSP)
181 03B2	3/4"	G 1/2
181 03B	3/4"	G 3/4
181 04B	1"	G 1
181 05B	1 1/4"	G 1 1/4
181 06B5	1 1/2"	G 1 1/4
181 06B	1 1/2"	G 1 1/2
181 07B	2"	G 2
181 09B8	3"	G 2 1/2
181 09B	3"	G 3
181 0AB	4"	G 4

**C** Accoppiatore femmina / Portagomma  
 Female coupler / Hose fitting  
 Acople hembra / Portaman-gueras

COD.	Corpo Size Cuerpo	Ø (BSP)
181 03C2	3/4"	13
181 03C	3/4"	19
181 04C	1"	25
181 04C5	1"	32
181 05C30	1 1/4"	30
181 05C	1 1/4"	32
181 06C5	1 1/2"	32
181 06C	1 1/2"	38
181 06C40	1 1/2"	40
181 07C	2"	50
181 07C53	2"	53
181 09C60	3"	60
181 09C8	3"	63
181 09C	3"	75
181 09C78	3"	78
181 09C87	3"	87
181 0AC105	4"	105

- Compatibili con gli accoppiatori MIL-C-27487
  - Leve di bloccaggio in acciaio INOX per una massima resistenza meccanica ed alla corrosione (2 leve nei modelli fino a 3" e 3 leve nei modelli da 4")
  - Il materiale impiegato, polipropilene rinforzato con fibra di vetro, assicura un'ottima resistenza meccanica e agli agenti chimici
  - Su richiesta disponibili anche in Nylon® rinforzato con fibra di vetro
  - Filettatura GAS (NPT a richiesta)
  - Nelle versioni con filettatura GAS femmina è presente la sede conica per la tenuta con O-ring (compatibile con tutta la nuova produzione di raccorderia ARAG)
  - Misure specifiche per montaggio con tubo LAYFLAT
  - Pressione di utilizzo max 9 BAR (130 PSI) per i modelli da 3/4" a 2"; max 5 BAR (75 PSI) per i modelli da 3" e 4"
  - Guarnizioni di tenuta standard in EPDM (Viton® e NBR a richiesta)
- Suitable to couplings MIL-C-27487
  - STAINLESS STEEL locking levers for maximum mechanical strength and corrosion resistance (2 locking levers up to 3" models and 3 levers for 4" models)
  - The material used, fibreglass-reinforced polypropylene, ensures excellent mechanical strength and good resistance against chemical agents
  - On request, also available in fibreglass-reinforced Nylon®
  - BSP threads (NPT on request)
  - A tapered seat for the O-ring seal is fitted in the female thread BSP versions (compatible with all new ARAG fittings)
  - Specific measurements for assembly with LAYFLAT tube
  - Max. working pressure 9 BAR (130 PSI) for the 3/4" to 2" models; max. 5 BAR (75 PSI) for the 3" and 4" models
  - EPDM standard gaskets (Viton® and NBR on request)

- Compatibles con los acoples MIL-C-27487
- Levas de bloqueo de acero INOX, máxima resistencia mecánica y a la corrosión (2 levas hasta modelos de 3" y 3 levas para el modelo de 4")
- El material utilizado, polipropileno reforzado con fibra de vidrio, asegura una óptima resistencia mecánica y a los agentes químicos
- A pedido están disponibles en Nylon® reforzado con fibra de vidrio
- Roscas disponibles GAS (NPT a pedido)
- Las versiones con rosca GAS hembra incorporan el asiento conico para la estanqueidad con O-ring (compatible con toda la nueva producción de racores ARAG)
- Medidas específicas para el montaje con tubo LAYFLAT
- Presión de utilización Máx 9 BAR (130 PSI) para los modelos de 3/4" a 2", máx. 5 BAR (75 PSI) para los modelos de 3" y de 4".
- Juntas de estanqueidad en EPDM (Viton® y NBR a pedido)

Possono essere accoppiati gli articoli aventi lo stesso colore.  
 The items with same color can be coupled together.  
 Es posible conectar los articulos que tienen el mismo color.



**D** Accoppiatore femmina / Filetto femmina  
 Female coupler / Female thread  
 Acople hembra / Rosca hembra

COD.	Corpo Size Cuerpo	F (BSP)
181 03D2	3/4"	G 1/2
181 03D	3/4"	G 3/4
181 04D	1"	G 1
181 05D	1 1/4"	G 1 1/4
181 06D5	1 1/2"	G 1 1/4
181 06D	1 1/2"	G 1 1/2
181 07D	2"	G 2
181 09D8	3"	G 2 1/2
181 09D	3"	G 3
181 0AD	4"	G 4



**E** Adattatore maschio / Portagomma  
 Male adapter / Hose fitting  
 Adaptador macho / Portamangueras

COD.	Corpo Size Cuerpo	Ø (BSP)
181 03E2	3/4"	13
181 03E	3/4"	19
181 04E	1"	25
181 04E5	1"	32
181 05E30	1 1/4"	30
181 05E	1 1/4"	32
181 06E5	1 1/2"	32
181 06E	1 1/2"	38
181 06E40	1 1/2"	40
181 07E	2"	50
181 07E53	2"	53
181 07E55	2"	55
181 09E60	3"	60
181 09E8	3"	63
181 09E	3"	75
181 09E78	3"	78
181 09E87	3"	87
181 0AE105	4"	105



**F** Adattatore maschio / Filetto maschio  
 Male adapter / Male thread  
 Adaptador macho / Rosca macho

COD.	Corpo Size Cuerpo	M (BSP)
181 03F2	3/4"	G 1/2
181 03F	3/4"	G 3/4
181 04F	1"	G 1
181 05F	1 1/4"	G 1 1/4
181 06F5	1 1/2"	G 1 1/4
181 06F	1 1/2"	G 1 1/2
181 07F	2"	G 2
181 09F8	3"	G 2 1/2
181 09F	3"	G 3
181 0AF	4"	G 4



**G** Tappo per accoppiatore femmina  
 Plug for female coupler  
 Tapón para acople hembra

COD.	Corpo Size Cuerpo
181 03G	3/4"
181 04G	1"
181 05G	1 1/4"
181 06G	1 1/2"
181 07G	2"
181 09G	3"
181 0AG	4"



**H** Tappo per adattatore maschio  
 Plug for male adapter  
 Tapón para adaptador macho

COD.	Corpo Size Cuerpo
181 03H	3/4"
181 04H	1"
181 05H	1 1/4"
181 06H	1 1/2"
181 07H	2"
181 09H	3"
181 0AH	4"



Molla anti apertura per Cam Lock  
 Locking spring for Cam-Lock couplers  
 Traba anti-apertura para acople rapido

COD.	Corpo Size Cuerpo
181 030	3/4"
181 040	1"
181 050	1 1/4"
181 060	1 1/2"
181 070	2"
181 090	3"

Possono essere accoppiati gli articoli aventi lo stesso colore.  
 The items with same color can be coupled together.  
 Es posible conectar los articulos que tienen el mismo color.

- Elimina aperture accidentali delle leve dovute a vibrazioni eccessive o urti
- It prevents accidental opening of the levers in case of strong vibrations or bumps
- Elimina el desenganche accidental de las levas, debido a bibraciones exesivas o golpes

VALVOLA A SFERA CON TIRANTI - 2 VIE

2 WAYS BOLTED VALVE

VALVULA DE BOLA CON TIRANTES - 2 VIAS

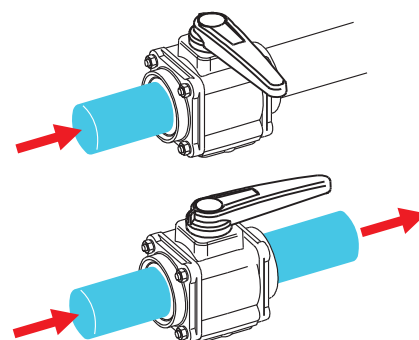

PP BALL COD.	INOX BALL COD.	Pressure		DN mm	F BSP	L mm	A mm	B mm	C mm	D mm	E mm	X mm	Y mm
		bar	PSI										
45300 4A44	45320 4A44	16	232	25	1" F	23	101	42	65	100	75	33	38
45300 4A55	45320 4A55			32	1" 1/4 F	25	105	42	65	100	75	33	38
45300 5A66	45320 5A66	10	145	40	1" 1/2 F	25	128	52	94	130	91	40	49
45300 6A77	45320 6A77			50	2" F	28	150	61	110	150	109	57	60
45300 7A88	45320 7A88	8	116	65	2" 1/2 F	33	168	71	125	200	127	72	80
45300 7A99	45320 7A99			65	3" F	36	174	71	125	200	127	72	80
45300 5E66	45320 5E66	10	145	40	1" 1/2 M	24	143	52	94	130	91	40	49
45300 6E77	45320 6E77			50	2" M	27	174	61	110	150	109	57	60
45300 7E88	45320 7E88	8	116	65	2" 1/2 M	32	206	71	125	200	127	72	80
45300 7E99	45320 7E99			65	3" M	35	212	71	125	200	127	72	80

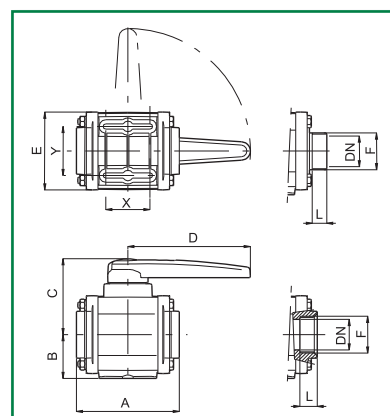

VALVOLA A SFERA CON TIRANTI, ATTACCO INFERIORE - 3 VIE

3 WAYS BOLTED VALVE, BOTTOM CONNECTION

VALVULA DE BOLA CON TIRANTES CONEXION INFERIOR - 3 VIAS

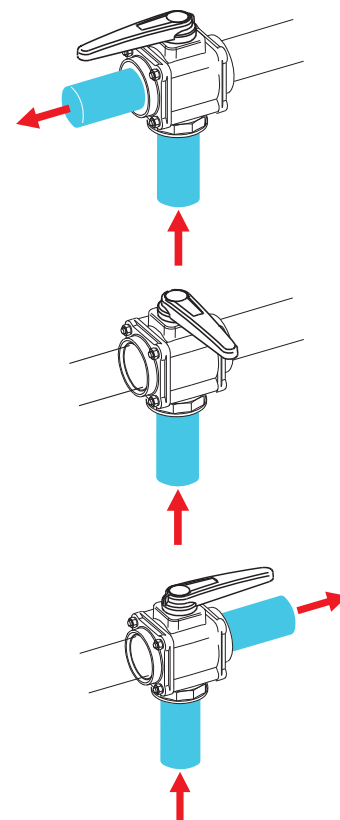
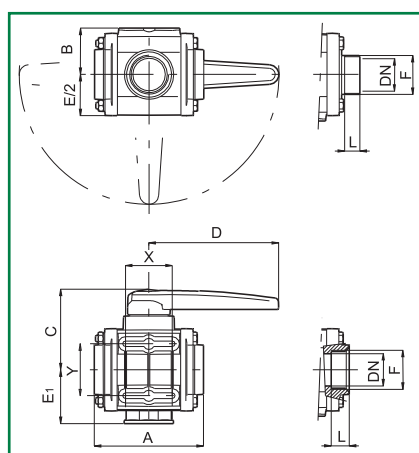

PP BALL COD.	INOX BALL COD.	Pressure		DN mm	F BSP	L mm	A mm	B mm	C mm	D mm	E mm	E1 mm	X mm	Y mm
		bar	PSI											
45302 4A44	45322 4A44	16	232	25	1" F	23	101	42	65	100	75	52	33	38
45302 4A55	45322 4A55			32	1" 1/4 F	25	105	42	65	100	75	58	33	38
45302 5A66	45322 5A66	10	145	40	1" 1/2 F	25	128	52	94	130	91	63	40	49
45302 6A77	45322 6A77			50	2" F	28	150	61	110	150	109	73	57	60
45302 7A88	45322 7A88	8	116	65	2" 1/2 F	33	168	71	125	200	127	88	72	80
45302 7A99	45322 7A99			65	3" F	36	174	71	125	200	127	94	72	80
45302 5E66	45322 5E66	10	145	40	1" 1/2 M	24	143	52	94	130	91	76	40	49
45302 6E77	45322 6E77			50	2" M	27	174	61	110	150	109	85	57	60
45302 7E88	45322 7E88	8	116	65	2" 1/2 M	32	206	71	125	200	127	90	72	80
45302 7E99	45322 7E99			65	3" M	35	212	71	125	200	127	107	72	80

Valvola a sfera a passaggio totale, sfera e asta in ottone, PN16.  
 Full bore ball valve, brass ball and stem, PN16.  
 Valvula de bola, esfera y varilla de latòn, PN16.



Valvola a sfera a passaggio totale, sfera e asta in ottone, PN16.  
 Full bore ball valve, brass ball and stem, PN16.  
 Valvula de bola, esfera y varilla de latòn, PN16.



Rubinetto a sfera a passaggio totale, sfera e asta in ottone, PN16.  
 Ball bib cock, brass ball and stem, PN16.  
 Grifo de bola a pasaje total, esfera y varilla de latòn, PN16.



COD.	F (BSP)
560 220	G 1/2 (F)
560 230	G 3/4 (F)
560 240	G 1 (F)
560 250	G 1 1/4 (F)
560 260	G 1 1/2 (F)
560 270	G 2 (F)

COD.	F (BSP)
560 220F	G 1/2 (F)
560 230F	G 3/4 (F)
560 240F	G 1 (F)

COD.	F (BSP)
560 120	G 1/2 (M)
560 130	G 3/4 (M)
560 140	G 1 (M)

Valvola a sfera Femmina/Femmina, PN10  
 Ball valve Female/Female, PN10  
 Valvula de bola Hembra/Hembra, PN10



COD.	F (BSP)	
F3150 0202	G 3/4 (F) x G 3/4 (F)	10
F3150 0303	G 1 (F) x G 1 (F)	10

Valvola a sfera Maschio/Femmina, PN10  
 Ball valve Male/Female, PN10  
 Valvula de bola Macho/Hembra, PN10



COD.	F (BSP)	
F3152 0202	G 3/4 (M) x G 3/4 (F)	10
F3152 0303	G 1 (M) x G 1 (F)	10



Mini valvola di derivazione/Tape con gommino  
Mini valve offtake dripper pipe with rubber  
Valvula para Tape con junta



Mini valvola filetto maschio/Tape  
Mini valve nipple dripper pipe  
Valvula mixta para Tape



Mini valvola portagomma/Tape  
Mini valve indented dripper pipe  
Valvula tubería/Tape



COD.	D (mm)	Foro / Drill (mm)	
F3171 0017	16	15	50

COD.	F (BSP)	D (mm)	
F3179 0117	G 1/2 (M)	16 Tape	50
F3179 0217	G 3/4 (M)	16 Tape	50

COD.	F (BSP)	
F3168 1617	16 x 16 Tape	50
F3168 2017	20 x 16 Tape	50

Mini valvola filettata Maschio, PN4  
Mini valve threaded Male, PN4  
Mini valvula rosca M/M, PN4



Mini valvola filettata Maschio/Femmina PN4  
Mini valve threaded Male/Female PN4  
Mini valvula rosca Macho/Hembra PN4



Mini valvola di Derivaz./Polietilene con gommino, PN4  
Mini valve gromet safety, PN4  
Mini valvula C.T.R. con junta, PN4



COD.	F (BSP)	
F3156 0101	G 1/2 (M) x G 1/2 (M)	50
F3156 0202	G 3/4 (M) x G 3/4 (M)	50

COD.	F (BSP)	
F3159 0101	G 1/2 (M) x G 1/2 (F)	50
F3159 0202	G 3/4 (M) x G 3/4 (F)	50

COD.	D (mm)	Foro / Drill (mm)	
F3172 0016	16	15	50
F3172 0020	20	15	50

Mini valvola filettata M. con portagomma, PN4  
Mini valve threaded /indented, PN4  
Mini valvula mixta Macho, PN4



Mini valvola filettata F. con portagomma, PN4  
Mini valve indented/nipple Female, PN4  
Mini valvula mixta Hembra, PN4



Mini valvola con portagomma, PN4  
Mini valve indented, PN4  
Mini valvula para tubería, PN4



COD.	D (mm)	F (BSP)	
F3161 0116	16	G 1/2 (M)	50
F3161 0120	20	G 1/2 (M)	50
F3161 0216	16	G 3/4 (M)	50
F3161 0220	20	G 3/4 (M)	50
F3161 0225	25	G 3/4 (M)	50

COD.	D (mm)	F (BSP)	
F3174 0161	16	G 1/2 (F)	50
F3174 0201	20	G 1/2 (F)	50
F3174 0162	16	G 3/4 (F)	50
F3174 0202	20	G 3/4 (F)	50
F3174 0252	25	G 3/4 (F)	50

COD.	D (mm)	
F3157 1616	16 x 16	50
F3157 2016	20 x 16	50
F3157 2020	20 x 20	50
F3157 2525	25 x 25	50

## GOMMINI DI RICAMBIO

## SPARE RUBBERS

## GOMAS DE REPUESTO



**Manicotto per Tape**  
Coupling Tape  
Enlance recto para Tape



COD.	D (mm)	
F3143 1717	16 x 16	100
F3143 2222	22 x 22	100

**Raccordo maschio per Tape**  
Nipple Tape  
Enlance mixta para Tape



COD.	D (mm)	F (BSP)	
F3148 0217	16	G 3/4 (M)	100
F3148 0222	22	G 3/4 (M)	100

**Derivazione senza gommino per Tape**  
Offtake Tape without rubber  
Conexion salida Tape



COD.	D (mm)	Foro / Drill (mm)	
F3142 0017	16	8	100

**Tappo terminale per Tape**  
Terminal Tape  
Tapon para Tape



COD.	D (mm)	
F3149 0017	16	100

**Derivazione con gommino per Tape**  
Offtake Tape with rubber  
Conexion salida Tape con junta



COD.	D (mm)	Foro / Drill (mm)	
F3135 0017	16	15	100

**Derivazione da Layflat per Tape**  
Starter Layflat  
Conexion para Layflat



COD.	D (mm)	
F3139 0017	16	100

**Anello fine linea**  
End line clamp  
Doble anillo para P.E.



COD.	D (mm)	
F3121 0016	16	100
F3121 0020	20	100
F3121 0025	25	100

**Gancio di sostegno**  
Support clip  
Soporte colgante P.E.



COD.	Ø (mm)	
652 900	16 - 20	500

**Derivazione filettata da Layflat per Tape**  
Threaded starter Layflat  
Conexion roscada para Layflat



COD.	F (BSP)	Foro / Drill (mm)	
F3510 0001	G 1/2 (F)	13	100
F3510 0002	G 3/4 (F)	13	100

**Manicotto con anello per ala gocciolante**  
Safety coupling  
Enlance de seguridad



COD.	D (mm)	D1 (mm)	
F3096 1616	16	16	100
F3096 2016	20	16	100
F3096 2020	20	20	100

**Derivazione senza gommino**  
Indented starter  
Conexion



COD.	D (mm)	Foro / Drill (mm)	
F3107 0016	16	8	100
F3107 0020	20	8	100

**Derivazione con gommino**  
Indented starter c/w rubber ring  
Conexion con junta



COD.	D (mm)	Foro / Drill (mm)	
F3108 0016	16	11	100
F3108 0020	20	11	100

Raccordo portagomma dritto filetto maschio  
Straight hosetail with male thread  
Enlance mixto



Raccordo portagomma curvo filetto maschio  
90° hosetail with male thread  
Conexion codo 90° mixta



Raccordo a "T" maschio  
Male Tee  
Conexion en "T" mixta



COD.	F (BSP)	D (mm)	
600 216	G 1/2 (M)	16	100
600 220		20	100
600 316	G 3/4 (M)	16	100
600 320		20	100
600 325		25	100
600 425	G 1 (M)	25	50
600 432		32	50
600 440	G 1 1/4 (M)	40	50
600 540		40	50

COD.	F (BSP)	D (mm)	
601 216	G 1/2 (M)	16	50
601 220		20	50
601 316	G 3/4 (M)	16	50
601 320		20	50
601 425	G 1 (M)	25	50
601 432		32	50

COD.	F (BSP)	D (mm)	
609 216	G 1/2 (M)	16	50
609 220		20	50
609 316	G 3/4 (M)	16	50
609 320		20	50
609 425	G 1 (M)	25	50
609 432		32	50

Manicotto dritto  
Straight coupling  
Enlance recto



Manicotto ridotto  
Reducer coupling  
Enlance reducido



Manicotto curvo  
90° coupling  
Conexion codo 90°



COD.	D (mm)	
604 016	16	100
604 020	20	100
604 025	25	100
604 032	32	100
604 040	40	50

COD.	D (mm)	D1 (mm)	
F3101 2016	20	16	100
F3101 2520	25	20	100
F3101 3225	32	25	100

COD.	D (mm)	D1 (mm)	
605 016	16	16	100
605 020	20	20	100
605 025	25	25	100
605 2532	25	32	100
605 032	32	32	100

Raccordo a "T"  
Tee  
Conexion en "T"



Raccordo portagomma dritto con girello  
Straight hosetail with fly nut  
Enlance con tuerca



Picchetto ancoraggio tubo  
Pipe anchorage  
Anclaje para tubos



COD.	D (mm)	D1 (mm)	
608 016	16	16	100
608 020	20	20	100
608 025	25	25	100
608 2532	32	25	100
608 032	32	32	100
608 040	40	40	20

COD.	F (BSP)	D (mm)	
602 216	G 1/2 (F)	16	100
602 316	G 3/4 (F)	16	100
602 320		20	100
602 416	G 1 (F)	16	100
602 420		20	100
602 425		25	100

COD.	D (mm)	D1 (mm)	
F3112 1620	16-20	145	100

Gocciolatori ispezionabili "Omega Clip"  
Inspectable hook drippers "Omega Clip"  
Goteadores ispeccionables "Omega Clip"



Gocciolatori ispezionabili "Omega Clip"  
Inspectable hook drippers "Omega Clip"  
Goteadores ispeccionables "Omega Clip"



Gocciolatori ispezionabili "Turbo Drip"  
Inspectable hook drippers "Turbo Drip"  
Goteadores ispeccionables "Turbo Drip"



COD.	Portata Delivery Caudal (l/h)	Pressione Pressure Presión (bar)	
650 005	5	1.5	250
650 008	8	1.5	250
650 016	16	1.5	250

COD.	Portata Delivery Caudal (l/h)	Pressione Pressure Presión (bar)	
650 105	5	1.5	250
650 108	8	1.5	250
650 116	16	1.5	250

COD.	Portata Delivery Caudal (l/h)	Pressione Pressure Presión (bar)	
650 204	4	1.5	500
650 208	8	1.5	500
650 216	16	1.5	500

Nebulizzatore a farfalla 360°  
Snap-in 360° minisprinkler  
Pulverizador 360°



Gocciolatore regolabile  
Adjustable dripper  
Goteador regulable



Gocciolatori regolabili  
Adjustable drippers  
Goteadores regulables



COD.	Foro Drill Agujero (mm)	Portata Delivery Caudal (l/h @1.5 bar)	Ø coperto Ø covered Ø cubierto (mm @1.5 bar)	
653 015	1.5	93	4.2	500
653 020	2.0	183	4.2	500
653 025	2.5	271	4.2	500
653 030	3.0	384	4.8	500
653 035	3.5	389	5.4	500
653 040	4.0	579	6.0	500

COD.	Portata Delivery Caudal (l/h)	Pressione Pressure Presión (bar)	
F3091 0000	0 ÷ 70	1.5	100

COD.	Portata Delivery Caudal (l/h)	Pressione Pressure Presión (bar)	
650 302	2 ÷ 100	1.5	500

Microspruzzo a 180°  
Pal mini sprayer 180°  
Microjet 180°



Microspruzzo a 360°  
Pal mini sprayer 360°  
Microjet 360°



Zampillo  
Jets  
Surtidor



Tappo  
Plug  
Tapón



COD.	Portata Delivery Caudal (l/h)	Ø coperto Ø covered Ø cubierto (mm)	
F3017 0060	60	2.5	100
F3017 0090	90	2.5	100
F3017 0120	120	2.5	100
F3017 0160	160	2.5	100

COD.	Portata Delivery Caudal (l/h)	Ø coperto Ø covered Ø cubierto (mm)	
F3018 0060	60	2.5	100
F3018 0090	90	2.5	100
F3018 0120	120	2.5	100
F3018 0160	160	2.5	100

COD.	Ø (mm)	
652 015	1.5	500
652 020	2	500

COD.	Ø (mm)	
652 000	4	500
F3059 0006	6	500
F3059 0008	8	500

**MANOMETRI ALLA GLICERINA**

- Cassa in ABS



Type 1



Type 2

COD.	Type	Scala Dial Escala	Class		
909 006	1	0 ÷ 6	2.5	63	G 1/4
909 010	1	0 ÷ 10			
909 025	2	0 ÷ 25			



**GLYCERINE FILLED PRESSURE GAUGES**

- ABS case



Type 3



Type 4

**MANÓMETROS DE GLICERINA**

- Caja en ABS

COD.	Type	Scala Dial Escala	Class		
910 002	3	0 ÷ 2.5	2.5	63	G 1/4
910 004	3	0 ÷ 4			
910 006	3	0 ÷ 6			
910 010	3	0 ÷ 10			
910 016	3	0 ÷ 16			
910 025	4	0 ÷ 25			

**POZZETTI ALLOGGIAMENTO VALVOLE**

Pozzetti interrabili per l'alloggiamento di valvole o elettrovalvole. Il coperchio, di colore verde, è facilmente mimetizzabile con il manto erboso ed il suo bordo di chiusura, a tenuta, non permette l'entrata di sporcizia all'interno del pozzetto.

**VALVE BOXES**

Digged valves box. The lid, green like the surrounding grass, with the sealing edge avoid dirt and dust inside.

**CAJA PARA VALVULAS**

Arquetas enterrables para valulas y electrovalvulas. La tapa verde se confunde facilmente con el color de la hierba y su borde hermetico evita la entrada de la suciedad dentro de la arqueta.



COD.	Tipo Type Tipo	Base Base Base (mm)	Coperchio Cover Tapa (mm)	h (mm)
F3212 0006	Cylindr.	Ø 200	Ø 160	235
F3212 0010	Cylindr.	Ø 310	Ø 240	255
F3212 0012	Rectang.	500 x 375	416 x 280	300
F4212 0014	Jumbo	640 x 500	500 x 350	300

**NASTRO IN TEFLON®  
TEFLON® BAND  
CINTA DE TEFLON®**



COD.	Type	
590 010*	1/2" x 12 mt	10

\* Il codice si riferisce ad un singolo rotolo di nastro.  
The code is referred to a single tape roll.  
El codiggo se refiere a un solo rollo.

**FUSTELLA FORATUBO PER TUBO IN POLIETILENE  
PUNCHING DRILL FOR POLYETHYLENE PIPE  
SACABOCADOS PARA TUBOS EN POLIETILENO**



COD.	Ø foro Hole Ø Agujero (mm)
652 911	3.6
652 912	4
652 913	5
652 914	6
652 915	7
652 916	8
652 917	9
652 918	10