

PISTOLE DA TRAVASO PER COMBUSTIBILI (GASOLIO)

- Corpo in Polipropilene
- Guarnizioni in NBR
- Parti interne in acciaio inox
- Raccordo girevole



FUEL TRANSFER GUN

- Polypropylene body
- NBR gaskets
- Stainless steel parts
- Swivel coupling

PISTOLA DE TRASRIEGO PARA COMBUSTIBLES (DIESEL)

- Cuerpo de Polipropilene
- Juntas de NBR
- Partes interiores de acero Inox
- Racor giratorio

COD.	Ø interno Internal Ø Ø interior	
	(mm)	(inches)
506 532	13	1/2"
506 530	19	3/4"
506 531	25	1"

PISTOLE DA TRAVASO

- Corpo in Polipropilene compatibile al contatto alimentare
- Guarnizioni in Viton®
- Parti interne in acciaio inox
- Raccordo girevole

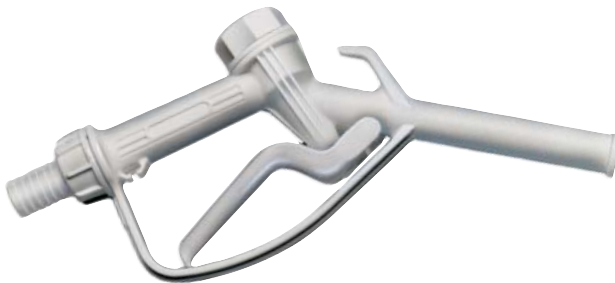

TRANSFER GUN

- Food contact compatible polypropylene body
- Viton® gaskets
- Stainless steel parts
- Swivel coupling

PISTOLA DE TRASRIEGO

- Cuerpo de polipropileno compatible para el contacto con alimentos
- Juntas de Viton®
- Partes interiores de acero Inox
- Racor giratorio

COD.	Ø interno Internal Ø Ø interior	
	(mm)	(inches)
506 542	13	1/2"
506 540	19	3/4"
506 541	25	1"

PISTOLE DA TRAVASO IN ALLUMINIO CON RACCORDO GIREVOLE



ALUMINIUM TRANSFER GUN WITH SWIVEL COUPLING

PISTOLA PARA TRASRIEGO DE ALUMINIO CON RACOR GIRATORIO

COD.	Ø interno Internal Ø Ø interior	
	(mm)	(inches)
506 522	G 1 (BSP) Femmina - Female - Hembra	
506 515	19	3/4"
506 516	25	1"

CONTALITRI MECCANICO VOLUMETRICO

Contalibri volumetrico per la misurazione privata di Gasolio, Benzina, Kerosene e Lubrificanti.

- Totalizzatore a 6 cifre e contatore parziale a 3 cifre.
- Applicabile a pompe o per gravità.
- Corpo in polipropilene.

Non è idoneo alla misurazione di prodotti per la vendita al pubblico.

MECHANICAL LITER COUNTER

Volumetric liter counter for fuel, gasoline, kerosene and lubricants.

- 6-numbers counter c/w partial 3-numbers counter.
- Suitable for pumps or gravity feeding.
- Polypropylene body.

Not available for retail sale.

CONTADOR MECANICO DE LITROS

Contador de litros para medir privatamente el gasoleo, la gasolina, el kerosene y los lubricantes.

- Totalizador de 6 cifras y contador parcial de 3 cifras.

• Montable sea con bombas sea por gravedad.
• Cuerpo de polipropileno.

Solo para uso privado.



COD.	In / Out
515 030	G 3/4
515 040	G 1

CARATTERISTICHE - CHARACTERISTICS - CARACTERISTICAS	
Unità di misura / Unit of measure / Unidad de medida	litri / litres / litros
Portata / Flow rate / Caudal - (min / MAX)	20 ÷ 80
Pressione di utilizzo / Working pressure / Presión de trabajo	0.1 ÷ 3.5 bar
Precisione / Accuracy / Precisión	± 1%
Risoluzione / Resolution / Resolución	0.1 litri / litres / litros
Temperatura / Temperature / Temperatura - (min / MAX)	-10 ÷ 50 °C
Peso / Weight / Peso	1.35 kg (mod. 515 040) 1.45 kg (mod. 515 030)

FILTRI A CARTUCCIA

La testa del contenitore è fornita completa di valvola di sfiato.

Non lavare il vaso con detersivi acidi, diluenti, benzina, o gasolio.

CARTRIDGE FILTERS

The housing head is normally supplied with relief valve.

Don't clean the bowl with detergent, acids, diluents, benzine or diesel oil.

COD.	IN	OUT	Altezza Height Altura
A2010 070	G 3/4 F	G 3/4 F	9" 3/4
A2010 110	G 1 F	G 1 F	9" 3/4
A2010 150	G 1 1/4 F	G 1 1/4 F	9" 3/4

FILTROS A CARTUCHO

La cabeza de el recipiente es completa de valvula de expulsión.

No limpien el vaso con detersivos acidos, diluyentes, gasolina o gasoleo.

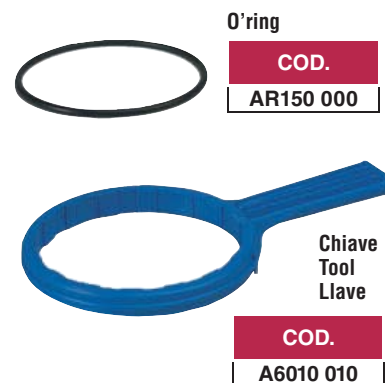
RICAMBI - SPARE PARTS - REPUESTOS

Cartucce idonee al trattamento delle impurità contenute nell'acqua.

I passaggi in micron determinano il tipo di filtrazione.

Elements for water filtering.

Microns determinate the filtering.

Cartuchos idoneos para el filtraje del agua.

Los pasajes en micron determinan el tipo de filtraje.

RETE LAVABILE
WASHABLE SCREEN
RED LAVABLE

COD.	Altezza Height Altura	micron
A4030 030	9" 3/4	80
A4030 070*	9" 3/4	80

* Solo per filtri con IN/OUT G 1 1/4
 Only for filter with IN/OUT G 1 1/4
 Solo para filtros con IN/OUT G 1 1/4

FILO AVVOLTO
WOUND THREAD
HILO ARROLLADO

COD.	Altezza Height Altura	micron	
A4010 290	9" 3/4	20	2
A4010 690*	9" 3/4	20	2

* Solo per filtri con IN/OUT G 1 1/4
 Only for filter with IN/OUT G 1 1/4
 Solo para filtros con IN/OUT G 1 1/4

CARTUCCE FILTRANTI

Ai carboni attivi:

- Filtrano e trattengono odori e sapori cattivi

Ai sali polisolfati:

- Mantengono in sospensione il calcare

FILTERING CARTRIDGES

Active charcoal cartridge

- They filter and preserve from bad smell and taste

Polyphosphates salt cartridge:

- They keep in suspension the limestone

CARTUCHOS DE FILTRAJE

De carbones activos

- Filtran y previenen los olores y los sabores malos

De sales polisulfatos

- Detienen en suspensión la caliza

CARTUCCIA AI CARBONI ATTIVI
ACTIVATED CARBON
CARTUCHOS DE CARBONES ACTIVOS

COD.	Altezza Height Altura
A4120 030	9" 3/4

CARTUCCIA AI SALI POLIFOSFATI
POLYPHOSPHATES SALT
CARTUCHO DE SALES POLIFOSFATOS

Non idonee per uso alimentare
Not suitable for food
No es idoneo para alimenticios

COD.	Altezza Height Altura
A4130 030	9" 3/4



NYLON

Raccordo in 3 pezzi a sede conica con portagomma dritto
3-Piece hosetail conical seat
Racor recto de 3 piezas de asiento conico

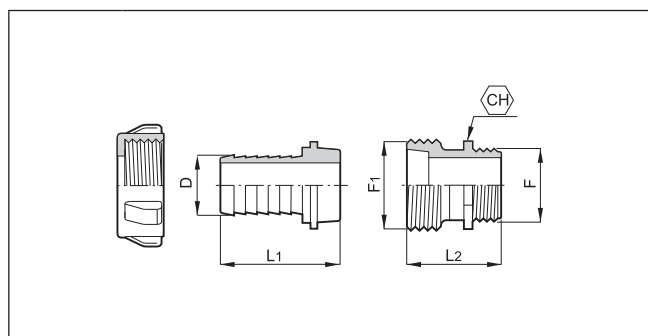

COD.	F (BSP)	D (mm)	L1 (mm)	L2 (mm)	F1	CH (mm)	
626 320	G 3/4	20	44.5	34	M29x1.75	27	20
626 322		22	52.5	43	M42x3	27	20
626 325		25	52.5	43	M42x3	27	20
626 420	G 1	20	44.5	35.5	M29x1.75	32	20
626 422		22	52.5	43	M42x3	32	20
626 425		25	52.5	43	M42x3	32	20
626 430		30	60	43	M42x3	32	20
626 432		32	66	43	M42x3	32	20
626 435		35	68	52	M52x3	38	20
626 440		40	68	52	M52x3	38	20
626 525	G1 1/4	25	52.5	52	M42x3	38	10
626 530		30	60	52	M42x3	38	10
626 532		32	66	52	M42x3	38	10
626 535		35	68	52	M52x3	38	10
626 538		38	67	52	M52x3	38	10
626 540	40	68	52	M52x3	38	10	
626 632	G1 1/2	32	66	52	M42x3	46	10
626 635		35	68	52	M52x3	46	10
626 638		38	67	52	M52x3	46	10
626 640		40	68	52	M52x3	46	10
626 650	G 2	50	76	52	M67x3	46	10
626 750		50	76	52	M67x3	56	5
626 760		60	89.5	56.5	M73x4	62	5



NYLON

Raccordo in 3 pezzi a sede conica con portagomma curvo
3-Piece elbow conical seat
Racor curvo de 3 piezas de asiento conico

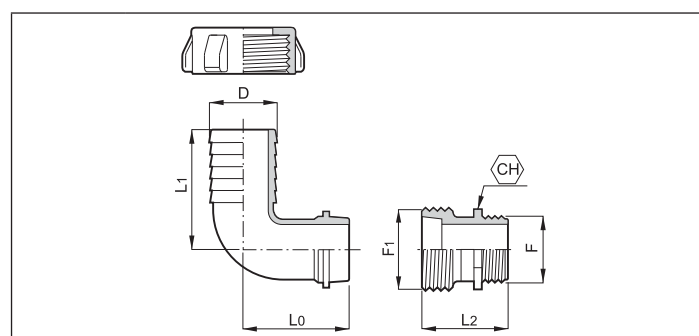

COD.	F (BSP)	D (mm)	L0 (mm)	L1 (mm)	L2 (mm)	F1	CH (mm)	
627 320	G 3/4	20	36.7	45	34	M29x1.75	27	20
627 322		22	50	53	43	M42x3	27	20
627 325		25	50	53	43	M42x3	27	20
627 420	G 1	20	36.7	45	35.5	M29x1.75	32	20
627 422		22	50	53	43	M42x3	32	20
627 425		25	50	53	43	M42x3	32	20
627 430		30	53	60	43	M42x3	32	20
627 432		32	53	60	43	M42x3	32	20
627 435		35	64.5	78	52	M52x3	38	20
627 440		40	64.5	85.4	52	M52x3	38	20
627 525	G1 1/4	25	50	53	52	M42x3	38	10
627 530		30	53	60	52	M42x3	38	10
627 532		32	53	60	52	M42x3	38	10
627 535		35	64.5	78	52	M52x3	38	10
627 538		38	64.5	84.5	52	M52x3	38	10
627 540	40	64.5	84.5	52	M52x3	38	10	
627 632	G1 1/2	32	53	60	52	M42x3	46	10
627 635		35	64.5	78	52	M52x3	46	10
627 638		38	64.5	84.5	52	M52x3	46	10
627 640		40	64.5	84.5	52	M52x3	46	10
627 650	G 2	50	76	90	52	M67x3	46	10
627 750		50	76	90	52	M67x3	56	5



NYLON

Raccordo curvo con girello
Hosetail 90° with fly nut
Racor curvo con tuerca

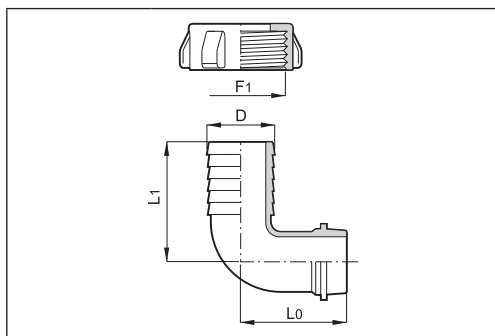

COD.	F1	D (mm)	L0 (mm)	L1 (mm)	
627 220.060	M29x1.75	20	36.7	45	20
627 422.060	M42x3	22	50	53	20
627 425.060		25	50	53	20
627 430.060		30	53	60	20
627 432.060		32	53	60	20
627 635.060	M52x3	35	64.5	78	10
627 638.060		38	64.5	84.5	10
627 640.060		40	64.5	84.5	10
627 750.060	M67x3	50	76	90	5



NYLON

Giunto combinato dritto
Dual hosetail
Doble racor con tuerca

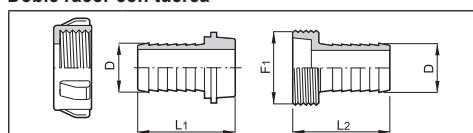

COD.	D (mm)	L1 (mm)	L2 (mm)	F1	
628 220	20	44.5	44.5	M29x1.75	20
628 425	25	52.5	52.5	M42x3	20
628 430	30	60	61	M42x3	20
628 432	32	66	60	M42x3	20
628 635	35	68	68	M52x3	10
628 638	38	67	68	M52x3	10
628 640	40	68	68	M52x3	10
628 750	50	76	73	M67x3	10
628 860	60	89.5	96	M73x4	5



NYLON

Raccordo dritto con girello
Hosetail with fly nut
Racor recto con tuerca

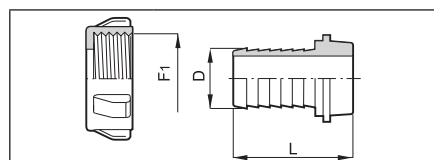

COD.	F1	D (mm)	L (mm)	
626 220.060	M29x1.75	20	44.5	20
626 422.060	M42x3	22	52.5	20
626 425.060		25	52.5	20
626 430.060		30	60	20
626 432.060		32	66	20
626 635.060	M52x3	35	68	10
626 638.060		38	67	10
626 640.060		40	68	10
626 750.060	M67x3	50	76	5
626 860.060	M73x4	60	89.5	5



NYLON

Raccordo portagomma dritto con filetto maschio
Straight hosetail with male thread
Racor recto portamanguera rosca macho

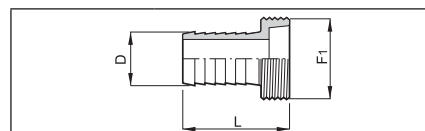

COD.	F1	D (mm)	L (mm)	
628 220.040	M29x1.75	20	44.5	20
628 425.040	M42x3	25	52.5	20
628 430.040		30	61	20
628 432.040		32	60	20
628 635.040		35	68	10
628 638.040	M52x3	38	68	10
628 640.040		40	68	10
628 750.040		M67x3	50	73
628 860.040	M73x4	60	96	5



NYLON

Nipplo
Nipple
Union M-M

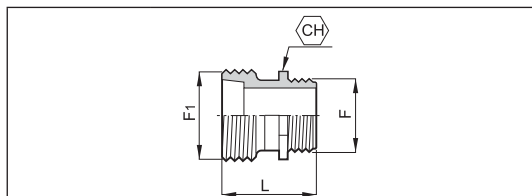

COD.	F (BSP)	F1	L (mm)	CH (mm)	
626 302.010	G 3/4	M29x1.75	34	27	20
626 304.010		M42x3	43	27	20
626 402.010	G 1	M29x1.75	35	32	20
626 404.010		M42x3	43	32	20
626 406.010	G1 1/4	M52x3	43	38	20
626 504.010		M42x3	52	38	10
626 506.010	G1 1/2	M52x3	52	38	10
626 604.010		M42x3	52	46	10
626 606.010	G2	M52x3	52	46	10
626 607.010		M67x3	52	46	10
626 707.010	G 2	M67x3	52	56	5
626 708.010		M73x4	56.5	62	5



NYLON

Girello
Fly nut
Tuerca para racor

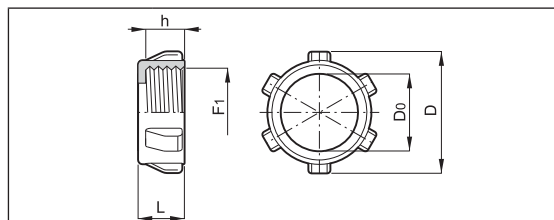

COD.	F1	h (mm)	L (mm)	D (mm)	D0 (mm)	
626 002.050	M29x1.75	11.5	14.5	41	22.5	20
626 004.050	M42x3	17.5	21	55	35	20
626 006.050	M52x3	19.5	23	67	44.5	10
626 007.050	M67x3	20.5	24	83	55	10
626 008.050	M73x4	20	24	92	62	5



POLYPROPYLENE

Tappo di scarico con guarnizioni passaparete
Drain plug with bulkhead gaskets
Tapón de descarga con juntas passapared

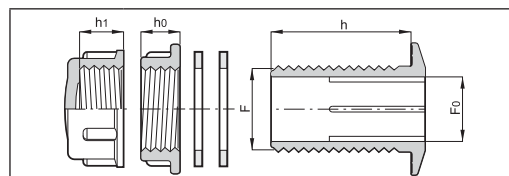

COD.	F (BSP)	h (mm)	F0 (mm)	h0 (mm)	h1 (mm)	
220 029B	G 1/2	43	14	13	15	20
220 039B	G 3/4	36	18	13	13.5	20
220 049B	G 1	54	25	15	17	20
220 059B	G1 1/4	38	32	14	13.5	10
220 069B	G1 1/2	46	38	15	16	10
220 079B	G 2	66.5	47.5	19.5	20	10



POLYPROPYLENE

Tappo femmina
Blank cap
Tapon hembra

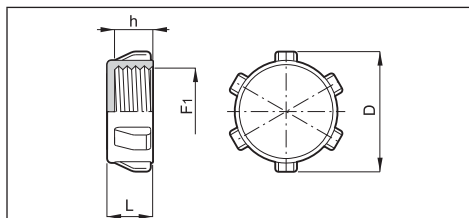

COD.	F1	h (mm)	L (mm)	D (mm)	
626 1012	M29x1.75	11.5	14.5	41	20
626 1013	M37x3	17	20	50	20
626 1014	M42x3	17.5	21	55	20
626 1016	M52x3	19.5	23	65	10
626 1017	M67x3	20.5	24	83	5
626 1018	M73x4	20	24	92	5

Guarnizioni per passaparete
Gaskets for bulkhead
Juntas para passapared

COD.	M (BSP)	
G50002	G 1/2	50
G50003	G 3/4	50
G50004	G 1	50
G50005	G1 1/4	50
G50006	G1 1/2	50
G50007	G 2	25



NYLON

Raccordo portagomma dritto con filetto maschio
Straight hosetail with male thread
Racor recto portamanguera rosca macho

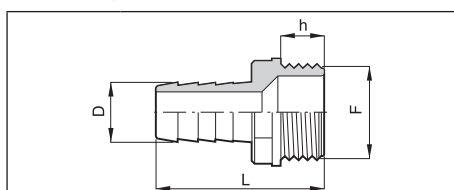

COD.	F (BSP)	D (mm)	h (mm)	L (mm)	
629 2008		8	13	47	20
629 2010	G 1/4	10	13	52	20
629 2013		13	13	52	20
629 2108		8	16	52	20
629 2110	G 3/8	10	16	57	20
629 2113		13	16	57	20
629 2115		16	16	57	20
629 2210		10	18	60	20
629 2213	G 1/2	13	18	60	20
629 2215		16	18	60	20
629 2220		20	18	65	20
629 2313		13	22	66	20
629 2315	G 3/4	16	22	66	20
629 2320		20	22	71	20
629 2322		22	22	71	20
629 2325		25	22	71	20
629 2420		20	22	72.5	20
629 2422	G 1	22	22	72.5	20
629 2425		25	22	72.5	20
629 2430		30	22	72.5	20
629 2432		32	22	72.5	20
629 2520		20	24	75	20
629 2525	G1 1/4	25	24	75	20
629 2530		30	24	80	20
629 2532		32	24	80	20
629 2535		35	24	85	20
629 2538		38	24	85	20
629 2540		40	24	90	20
629 2630		30	24	80	10
629 2632	G1 1/2	32	24	80	10
629 2635		35	24	85	10
629 2638		38	24	85	10
629 2640		40	24	90	10
629 2645		45	24	90	10
629 2650		50	24	95	10
629 2750	G 2	50	27	101	10
629 2760		60	27	112.5	10
629 2860	G2 1/2	60	32	120	10
629 2975	G 3	75	35	138.5	10



NYLON

Raccordo portagomma curvo con filetto maschio
90° hosetail with male thread
Racor curvo portamanguera rosca macho

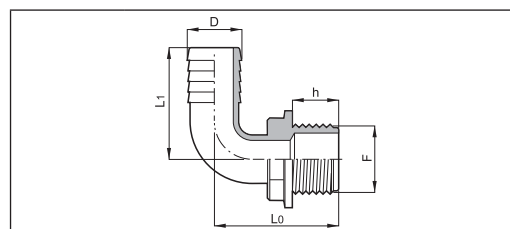

COD.	F (BSP)	D (mm)	h (mm)	L0 (mm)	L1 (mm)	
630 2113	G 3/8	13	16	41	45	20
630 2115		16	16	41	48	20
630 2213	G 1/2	13	18	44	45	20
630 2215		16	18	44	48	20
630 2220		20	18	44	53	20
630 2313	G 3/4	13	22	50	45	20
630 2315		16	22	50	48	20
630 2320		20	22	50	53	20
630 2325		25	22	59	53	20
630 2420	G 1	20	22	50	53	20
630 2425		25	22	59	53	20
630 2430		30	22	60	60	20
630 2432		32	22	60	60	20
630 2525		25	24	65.5	53	20
630 2530	G1 1/4	30	24	62	60	20
630 2532		32	24	62	60	20
630 2535		35	24	70	80	20
630 2538		38	24	70	84.5	20
630 2540		40	24	70	84.5	20
630 2630	G1 1/2	30	24	62	60	10
630 2632		32	24	62	60	10
630 2635		35	24	70	80	10
630 2638		38	24	70	84.5	10
630 2640		40	24	70	84.5	10
630 2750	G 2	50	27	88	89	10
630 2752		52	27	88	89	10
630 2960	G 3	60	35	125	120	5
630 2975		75	35	125	125	5

VALVOLA DI FONDO CON FILTRO

- Polipropilene



FOOT VALVE C/W FILTER

- Polypropylene body

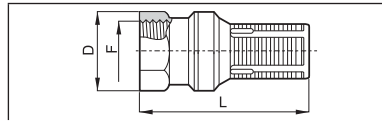

COD.	F (BSP)	D (mm)	L (mm)	
504 304.1	G 1	40	100	20

VALVULA DE FONDO CON FILTRO

- Cuerpo de polipropileno

RACCORDI A MORSETTO



NYLON

CLAMP FITTINGS



RACOR A BORNE



Raccordo portagomma
 Hosetail
 Racor portamanguera

Tappo
 Blank cap
 Tapon

Guarnizione
 Gasket
 Junta

Morsetto inox
 Stainless steel clamp
 Borne inox

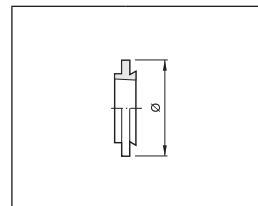
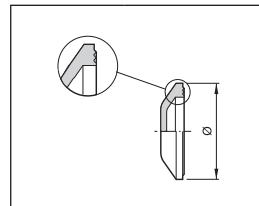
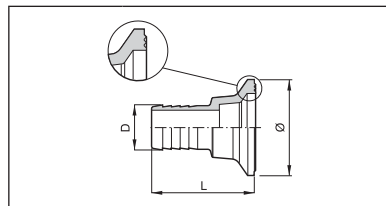

COD.	Ø	
552 0411	40	10
552 0511	50	10
552 0611	60	10

COD.	Ø	D (mm)	L (mm)	
552 0430	40	30	71.5	10
552 0440		40	78	10
552 0450		50	87	10
552 0530	50	30	70.5	10
552 0540		40	78	10
552 0550		50	87	10
552 0650	60	50	87	10
552 0660		60	92	10

COD.	Ø	
552 0400	40	10
552 0500	50	10
552 0600	60	10

COD.	Ø	
552 0401	40	10
552 0501	50	10
552 0601	60	10

FILTRO

- Polipropilene compatibile al contatto alimentare



FILTER

- Food contact compatible polypropylene body

FILTRO

- Cuerpo de polipropileno compatible para el contacto con alimentos

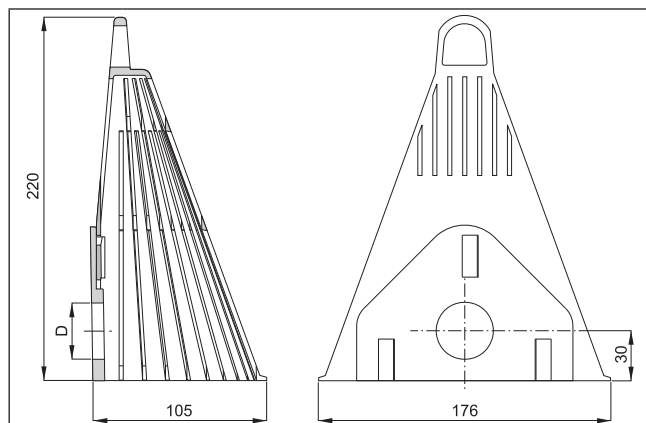

COD.	D (mm)	D (BSP)
550 202	21	G 1/2
550 203	26.5	G 3/4
550 204	33.5	G 1
550 205	42	G 1 1/4

VALVOLA A SFERA

- Corpo in Polipropilene compatibile al contatto alimentare
- Tenuta a sfera in Teflon®
- Guarnizioni in NBR

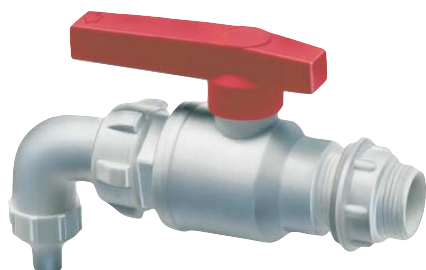

BALL VALVE

- Food contact compatible polypropylene body
- Ball seal in Teflon®
- NBR gaskets

COD.	F		D (mm)	h (mm)	s (mm)	
	(BSP)	Type				
456 121	G 1/2	F	20	19	-	10
456 132	G 3/4	F	25	19	-	10
456 142	G 1	F	25	20	-	10
456 143		F	30	20	-	10
456 221	G 1/2	M	20	30	15	10
456 232	G 3/4	M	25	30	15	10
4562 421	G 1	M	25	40	22	10
4562 431		M	30	40	22	10
456 253	G 1 1/4	M	30	32	14	10

VALVOLA DE BOLA

- Cuerpo de polipropileno compatible para el contacto con alimentos
- Asiento de la bola en Teflon®
- Juntas en NBR

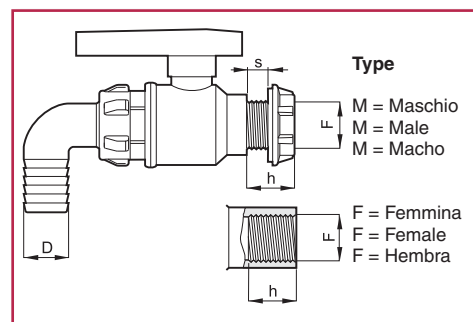

COD.	F		D (mm)	h (mm)	s (mm)	
	(BSP)	Type				
456 126	G 1/2	F	13	19	-	10
456 137	G 3/4	F	13	19	-	10
456 147	G 1	F	13	20	-	10
456 148		F	14	20	-	10
456 226	G 1/2	M	13	30	15	10
456 237	G 3/4	M	13	30	15	10
4562 471	G 1	M	13	40	22	10
4562 481		M	14	40	22	10
456 258	G 1 1/4	M	14	32	14	10

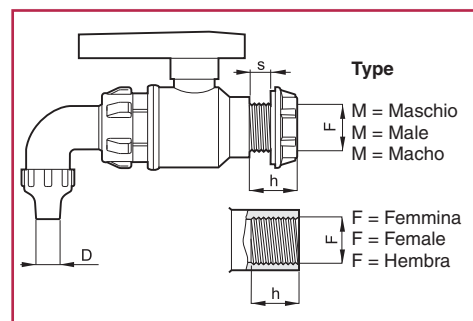

CURVE PER IMBOTTIGLIAMENTO

- Polipropilene compatibile al contatto alimentare



BOTTLING ELBOW

- Food contact compatible polypropylene body

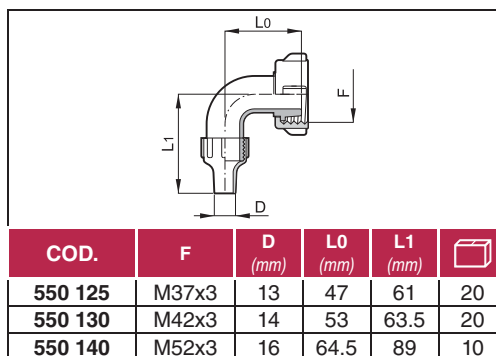
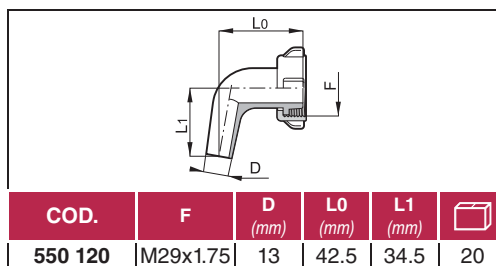

CODO PARA EMBOTELLAMENTO

- Cuerpo de polipropileno compatible para el contacto con alimentos

RUBINETTO A SPILLO

- Corpo in Polipropilene compatibile al contatto alimentare
- Guarnizioni in NBR



NEEDLE TAP

- Food contact compatible polypropylene body
- NBR gaskets

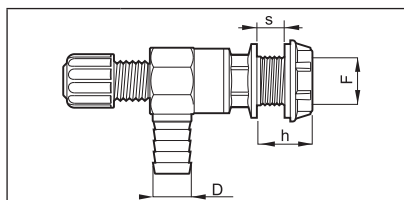

COD.	F (BSP)	D (mm)	h (mm)	s (mm)
554 216	G 1/2	16	30	15
554 320	G 3/4	20	30	15

GRIFO DE ALFILER

- Cuerpo de polipropileno compatible para el contacto con alimentos
- Juntas en NBR

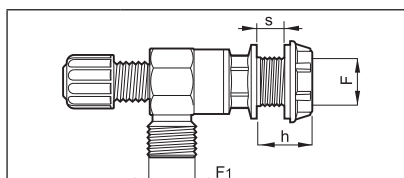

COD.	F (BSP)	F1 (BSP)	h (mm)	s (mm)
554 202	G 1/2	G 1/2	30	15
554 303	G 3/4	G 3/4	30	15

RUBINETTO ORIENTABILE

- Corpo in Polipropilene compatibile al contatto alimentare
- Guarnizioni in NBR



ORIENTABLE COCK

- Food contact compatible polypropylene body
- NBR gaskets

GRIFO ORIENTABLE

- Cuerpo de polipropileno compatible para el contacto con alimentos
- Juntas en NBR

COD.	F (BSP)	Uscita Outlet Salida (mm)	s (mm)	
555 3009	G 3/4	8.5	10	10

s = Tratto utile filetto (spessore max. tanica)

s = Maximum tank wall thickness

s = Espesor maximo de la cisterna



COD.	F (BSP)	Uscita Outlet Salida (mm)	s (mm)	
555 3018	G 3/4	17.5	10	10

s = Tratto utile filetto (spessore max. tanica)

s = Maximum tank wall thickness

s = Espesor maximo de la cisterna

TAPPI "MACON"

- Polipropilene compatibile al contatto alimentare



MACON LIDS

- Food contact compatible polypropylene body

COD.	Ø Macon	F (mm)	h (mm)	A (mm)	B (mm)
550 340A	40	M55x3	19.5	65	23
550 350A	50	M67x3	20.5	83	24
550 360A	60	M79x3.5	21	92	25
550 370A	70	M90x3.5	21	96	25
550 380A	80	M102x4	21	116	25

TAPON MACON

- Cuerpo de polipropileno compatible para el contacto con alimentos

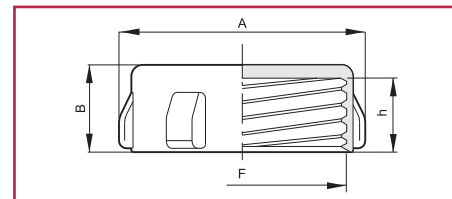

BY-PASS

- Polipropilene compatibile al contatto alimentare



BY-PASS

- Food contact compatible polypropylene body

COD.
550 020

BY-PASS

- Cuerpo de polipropileno compatible para el contacto con alimentos

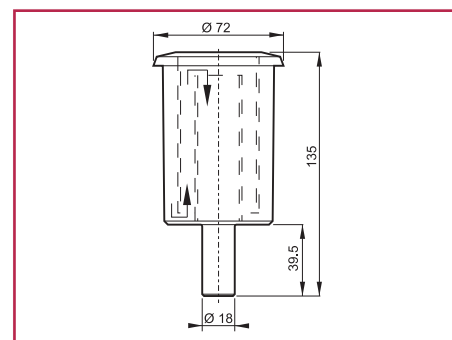

VALVOLE DI SFIATO A DOPPIO EFFETTO

- Corpo in Polietilene compatibile al contatto alimentare
- Guarnizioni in NBR



DOUBLE EFFECT OUTLET VALVES

- Food contact compatible polypropylene body
- NBR gaskets

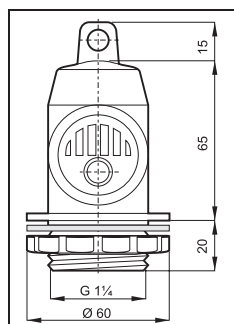

COD.	hl/h
550 032	150

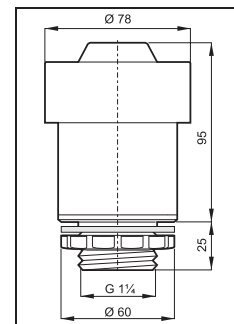

COD.	hl/h
550 034	500

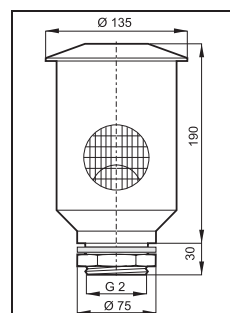

COD.	hl/h
550 036	1000